

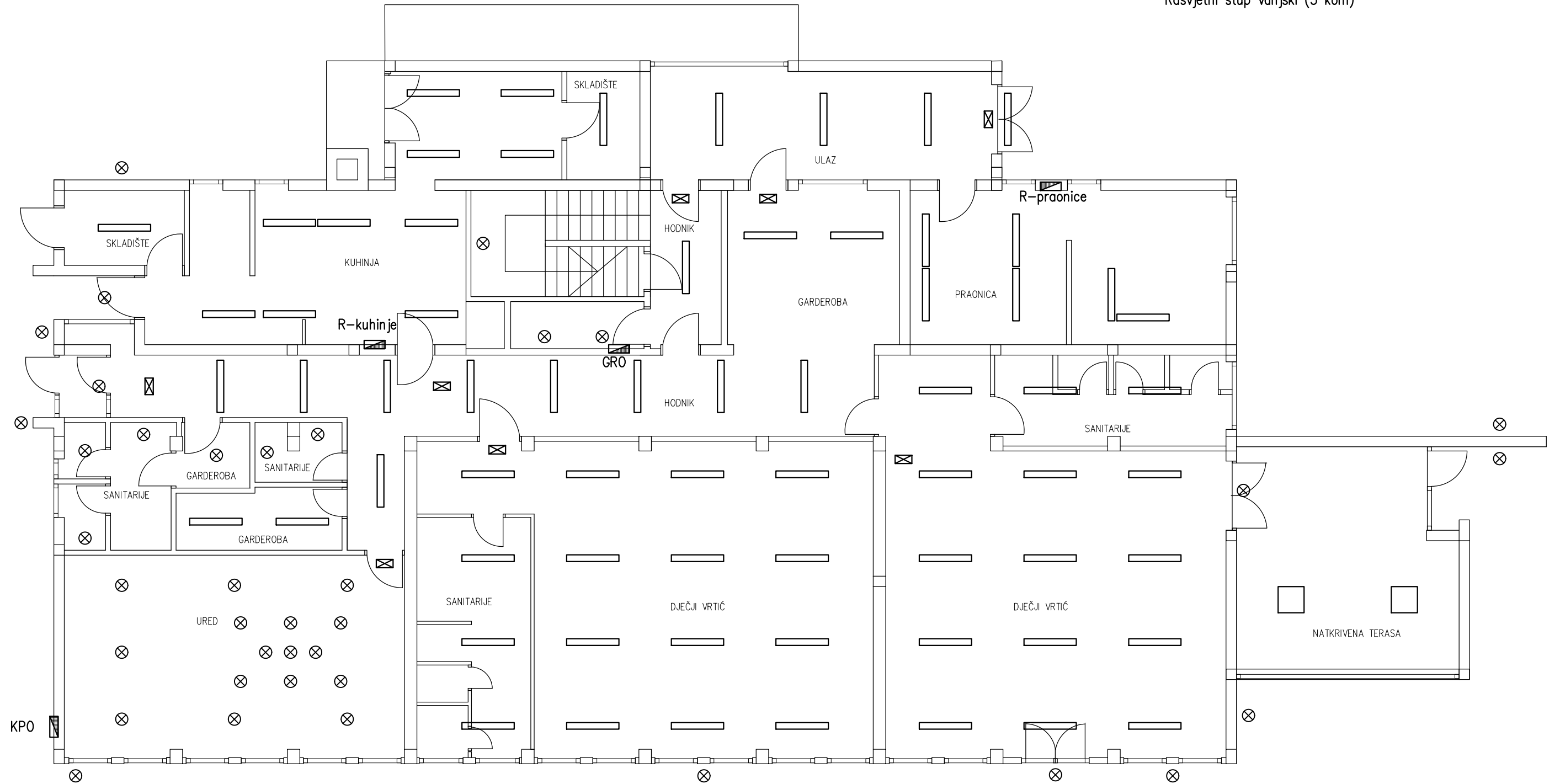

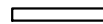



TLOCRT PRIZEMLJA

☒ Rasvjetni stup vanjski (3 kom)



-  Fluo 2x36W
-  Fluo 1x36W
-  Fluo 4x18W
-  Žarulja
-  Žarulja u rasvjetnom stupu
-  Panik svjetiljka (ne mijenja se)

NACRT: POSTOJEĆE STANJE RASVJETE - PRIZEMLJE PROJEKTANT: GORAN JUSTINIĆ, mag.ing.el.			
INVESTITOR: GRAD NOVI VINODOLSKI			
GRAĐEVINA: DV FIJOLICA - PROJEKT POVEĆANJA ENERGETSKE UČINKOVITOSTI			
LOKACIJA: NOVI VINODOLSKI, k.č.br. 3647/1, k.o. NOVI			